

The Omaha Standard 156 and 168 service bodies were specifically designed to fit Ford Super Duty dual rear wheel chassis with 108" to 120" CA. These bodies have 20" deep compartments with 54½" wide floors. The standard body height is 40"; top opening compartment models are 42" high.

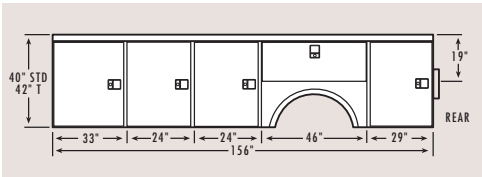

156 "V" CONFIGURATION-CLEAR DOOR OPENINGS	
COMPARTMENT	STANDARD & TOP OPENING
Front	27 ¼" w x 34" H
1st Intermediate	19 ¼" w x 34" H
2nd Intermediate	19 ¼" w x 34" H
Horizontal	43 ½" w x 14" H
Rear	23 ¼" w x 30" H

STANDARD MODELS									
MODEL	BODY LENGTH	CAB-TO AXLE (CA)	HEIGHT	FLOOR WIDTH	COMPARTMENTS		EXT. COMP. DEPTH	OVERALL WIDTH	APPROX. WEIGHT (LBS.)
					STREET SIDE	CURB SIDE			
156D54V	156"	108" Dual Wheel	40"	54½"	V	V	20"	95¾"	1733
156D54VH	156"	108" Dual Wheel	40"	54½"	V	H	20"	95¾"	1733
156D54H	156"	108" Dual Wheel	40"	54½"	H	H	20"	95¾"	1733
168D54V	168"	120" Dual Wheel	40"	54½"	V	V	20"	95¾"	1866
168D54VH	168"	120" Dual Wheel	40"	54½"	V	H	20"	95¾"	1866
168D54H	168"	120" Dual Wheel	40"	54½"	H	H	20"	95¾"	1866
TOP OPENING COMPARTMENT MODELS									
156D54VT	156"	108" Dual Wheel	42"	54½"	V	H	20"	95¾"	2107
156D54VHT	156"	108" Dual Wheel	42"	54½"	V	H	20"	95¾"	2107
156D54HT	156"	108" Dual Wheel	42"	54½"	H	H	20"	95¾"	2107
168D54VT	168"	120" Dual Wheel	42"	54½"	V	V	20"	95¾"	2240
168D54VHT	168"	120" Dual Wheel	42"	54½"	V	H	20"	95¾"	2240
168D54HT	168"	120" Dual Wheel	42"	54½"	H	H	20"	95¾"	2240

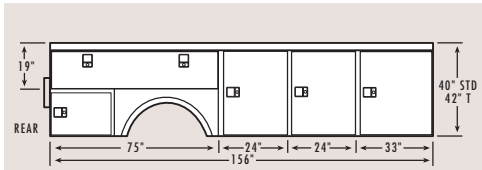

156 "H" CONFIGURATION-CLEAR DOOR OPENINGS	
COMPARTMENT	STANDARD & TOP OPENING
Front	27 ¼" w x 34" H
1st Intermediate	19 ¼" w x 34" H
2nd Intermediate	19 ¼" w x 34" H
Horizontal	71 ¼" w x 14" H
Bottom Rear	23 ¼" w x 15 ¼" H

"VH" Models are available in reverse configuration: i.e., "H" compartment configuration on the street side and "V" compartment configuration on the curb side. Specify "HV" when ordering. For compartment configurations other than shown, please consult the factory

NOTE: Both 156/168 top opening compartments models have two top opening compartments per side, each approximately 65" long.

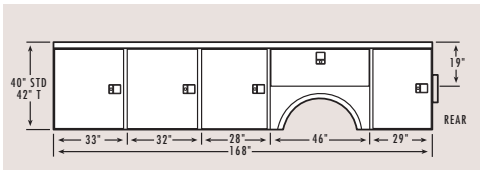

168 "V" CONFIGURATION-CLEAR DOOR OPENINGS	
COMPARTMENT	STANDARD & TOP OPENING
Front	27 ¼" w x 34" H
1st Intermediate	19 ¼" w x 34" H
2nd Intermediate	19 ¼" w x 34" H
Horizontal	43 ½" w x 14" H
Rear	23 ¼" w x 30" H

Standard Model Service Bodies include:

- 12" Rotary paddle latch pickup style slam tailgate
- Stainless steel rotary paddle latches on all doors
- Automotive door seals in all compartments
- Four (4) trays for front vertical compartments
- One (1) tray for "V" style horizontal compartment
- Galvanized steel tray dividers
- Shelves in rear vertical compartments
- Spring loaded over-center door retainers on all full-sized vertical doors
- Cable retainers on small vertical doors on "H" configuration
- Cable retainers on curb side and street side horizontal doors
- Bodies are factory prime painted with gray epoxy electrocoat
- Universal "Quick Mount" mounting kit

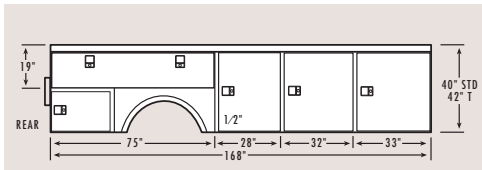

168 "H" CONFIGURATION-CLEAR DOOR OPENINGS	
COMPARTMENT	STANDARD & TOP OPENING
Front	27 ¼" w x 34" H
1st Intermediate	19 ¼" w x 34" H
2nd Intermediate	19 ¼" w x 34" H
Horizontal	71 ¼" w x 14" H
Bottom Rear	23 ¼" w x 15 ¼" H

SERVICE BODIES FOR IMPORTED TRUCKS

IMPORTED CHASSIS -132DV-BS

The model 132DV-BS is an 11' service body that mounts on a dual wheel chassis with an 88.4 inch CA measurement. It is a vertical configuration on both sides. Compartments are designed to clear fuel tanks and battery boxes.

IMPORTED CHASSIS -132DV-NPR-CTR

The model 132DV-CTR is an 11' service body that mounts on a dual wheel chassis with an 88.4 inch CA measurement. It is designed to clear center mounted fuel tanks and provide clearance for air filters on intake air systems.